



ЕВРО-4



СЕДЕЛЬНЫЕ ТЯГАЧИ
FIFTH-WHEEL TRACTORS



СЕДЕЛЬНЫЕ ТЯГАЧИ FIFTH-WHEEL TRACTORS



Предназначены для перевозки
различных грузов
в составе автопоезда

Designed for carrying forming part
of roadtrain of different loads

(4 2)

/ MAZ
-5440 3-1480

		-5440 3-1480-002 (-5440 3-1480-030**) (-031***)
	/ Possible gross mass of roadtrain, kg	36000
	/ Possible gross mass of truck, kg	18050
	/ Distribution of gross mass :	
-	/ On front axle, kg	6550
-	/ On rear axle, kg	11500
	/ Loading on fifth wheel, kgf	10950
	/ Equipped truck mass,kg	6950
/ Engine		-5361.10
	/ Power, kW / hp	198 / 269
/ Gearbox		9JS135 A
/ Number of speeds of the gearbox		9
	/ Gear ratio	5,33
	/ Maximum speed, km/h	85
Hs,	/ height of truck bolster, mm	1270 (1250**)(1150***)
	/ Fuel tank, l	300
	/ Tyres dimensions	315/70R22.5 (295/80R22.5*) (315/70R22.5**)
/ ab		6501 / small

*) / With speed-limiting device

/ Suspension
-5440 3-1480-002 - / few-leaf spring with stabilizer
(-5440 3-1480-030**) (-5440 3-1480-031***) - 4 / pneumatic 4 baloon
500 /

/ Technical data and dimension are given for standard configuration

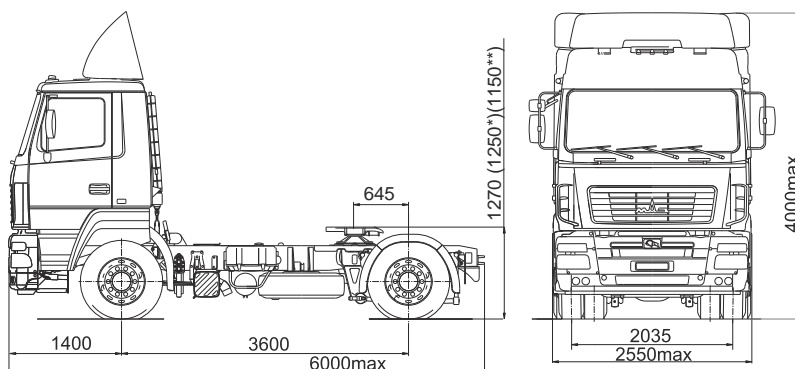



СЕДЕЛЬНЫЕ ТЯГАЧИ FIFTH-WHEEL TRACTORS

Предназначены для перевозки
различных грузов
в составе автопоезда

Designed for carrying forming part
of roadtrain of different loads

(4 2)

/ MAZ
-5440 5-8420
-5440 5-8480



	-5440 5-8420-002 (-5440 5-8420-030*) (-031**)	-5440 5-8480-002 (-5440 5-8480-030*) (-031**)
Possible gross mass of roadtrain, kg	40000	40000
Possible gross mass of truck, kg	17800	17800
/ Distribution of gross mass :		
- / On front axle, kg	6200	6300
- / On rear axle, kg	11500	11500
/ Loading on fifth wheel, kgf	10500	10500
/ Equipped truck mass, kg	7150	7150
/ Maximum speed, km/h	85	85
Hs, / Height of fifth wheel, mm	1270 (1250*) (1150**)	1270 (1250*) (1150**)
L, / Overall length L, mm	6200 (6000)	6200 (6000)
/ Engine	-536.10	-536.10
/ Power, kW / hp	228 / 310	228 / 310
/ Gearbox	ZF 9S1310 TO	9JS135
/ Number of speeds of the gearbox	9	9
/ Gear ratio	5,08	5,33
/ Fuel tank, l	500	500
/ Tyres dimensions	315/70R22.5(315/80R22.5*)(315/70R22.5**)	315/70R22.5(315/80R22.5*)(315/70R22.5**)
/ ab	5440 / large	5440 / large

*) / With speed-limiting device

/ Suspension

-5440 5-8420-002 -
-5440 5-8420-030 (-031) -

4

/ few-leaf spring with stabilizer
/ pneumatic 4 baloon
/ Technical data and dimension are given for standard configuration

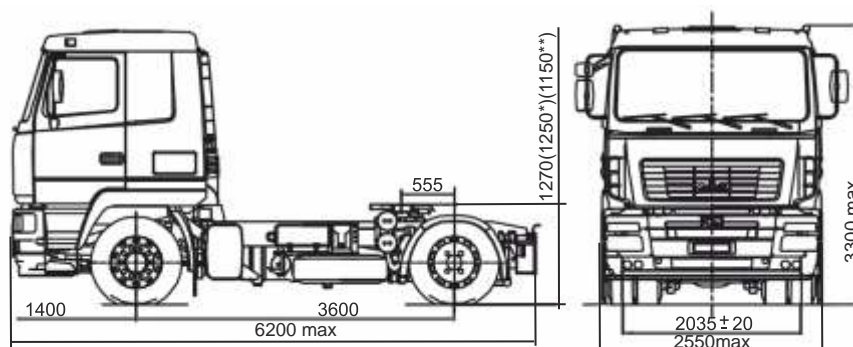



СЕДЕЛЬНЫЕ ТЯГАЧИ FIFTH-WHEEL TRACTORS



Предназначены для перевозки
различных грузов
в составе автопоезда

Designed for carrying forming part
of roadtrain of different loads

(4 2)

/ MAZ
-5440W8-1470

		-5440W8-1470-030 (-5440W8-1470-031)
	/ Possible gross mass of roadtrain, kg	44000
	/ Possible gross mass of truck, kg	18750
	/ Distribution of gross mass :	
-	/ On front axle, kg	7250
-	/ On rear axle, kg	11500
	/ Loading on fifth wheel, kgf	10550
	/ Equipped truck mass, kg	8050
	/ Maximum speed, km/h	85
	Hs, / Height of fifth wheel, mm	1250 (1150)
	(L), / Length not more (L), mm	6000
/ Engine		ISLe 400.40
	/ Power, kW / hp	294 / 400
/ Gearbox		12JS200T
/ Number of speeds of the gearbox		12
/ Rear suspension		4 / pneumatic 4 baloon
	/ Gear ratio	3.57(3,45)
	/ Fuel tank, l	500**
/ Tyres dimensions		315/80R22.5 (315/70R22.5)
/ ab		6431 / large

*) / With speed-limiting device
700 . 700+300 ./

/ Technical data and dimension are given for standard configuration

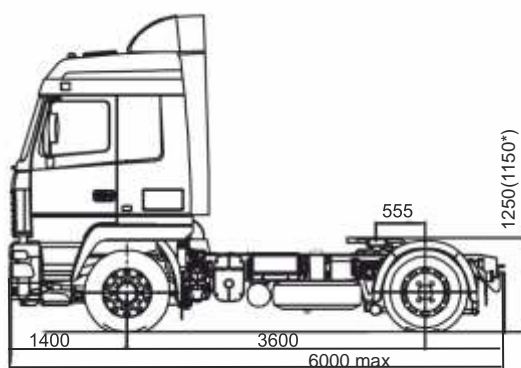



СЕДЕЛЬНЫЕ ТЯГАЧИ FIFTH-WHEEL TRACTORS

Предназначены для перевозки
различных грузов
в составе автопоезда

Designed for carrying forming part
of roadtrain of different loads

(4 2)

/ MAZ
-5440 9-1420
-5440 9-1480



-5440 9-1420-030, -5440 9-1470-030*
(-5440 9-1420-031, -5440 9-1470-031*)

Possible gross mass of roadtrain, kg	44000
Possible gross mass of truck, kg	18450
/ Distribution of gross mass :	
- / On front axle, kg	6950
- / On rear axle, kg	11500
, / Loading on fifth wheel, kgf	10500
, / Equipped truck mass, kg	7800
, / Maximum speed, km/h	85
Hs, / Height of fifth wheel, mm	1250(1150)
L, / Overall length L, mm	6000
/ Engine	
, / . . / Power, kW / hp	-651.10 309 / 420
/ Gearbox	
ZF 16S1820 TO (16JS200T *)	
/ Number of speeds of the gearbox	
16	
/ Gear ratio	
3,57 (3.45)	
/ Fuel tank, l	
500***	
/ Tyres dimensions	
315/80R22.5 (315/70R22.5)	
/ ab	
6431 / large	
/ Suspension	
4 / pneumatic 4 baloon	

**) / With speed-limiting device
***) 700 ./

/ Technical data and dimension are given for standard configuration

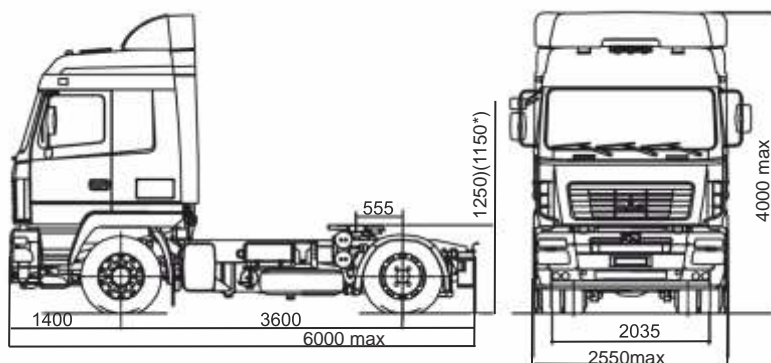



СЕДЕЛЬНЫЕ ТЯГАЧИ FIFTH-WHEEL TRACTORS



Предназначены для перевозки
различных грузов
в составе автопоезда

Designed for carrying forming part
of roadtrain of different loads

(4 2)

/ MAZ
-544019-1421
-5440 9-520

	-544019-1421-030 -544019-1421-031	-5440 9-520-030 (-5440 9-520-031)
, / Possible gross mass of roadtrain, kg	44000	44000
, / Possible gross mass of truck, kg	18750	18750
/ Distribution of gross mass :		
- , / On front axle, kg	7250	7250
- , / On rear axle, kg	11500	11500
, / Loading on fifth wheel, kgf	10700	10700
, / Equipped truck mass, kg	7900	7900
Hs, / Height of fifth wheel, mm	1250 (1150)	1250 (1150)
/ Engine	501LA.IV	501LA.V
, / . . / Power, kW / hp	320/412	320/412
/ Gearbox	ZF16S221	ZF16S221
/ Number of speeds of the gearbox	16	16
/	4 /	4 /
Rear suspension	pneumatic 4 baloon	pneumatic 4 baloon
/ Gear ratio	3.57 (3.45)	3.57 (3.45)
, / Fuel tank, l	500**	500**
, / / Maximum speed, km/h	100	100
/ Tyres dimensions	315/80R22.5 (315/70R22.5)	315/80R22.5
/ ab	6431 / large	6431 / large

*) / With speed-limiting device
**) 700 . 500+700 ./

/ Technical data and dimension are given for standard configuration

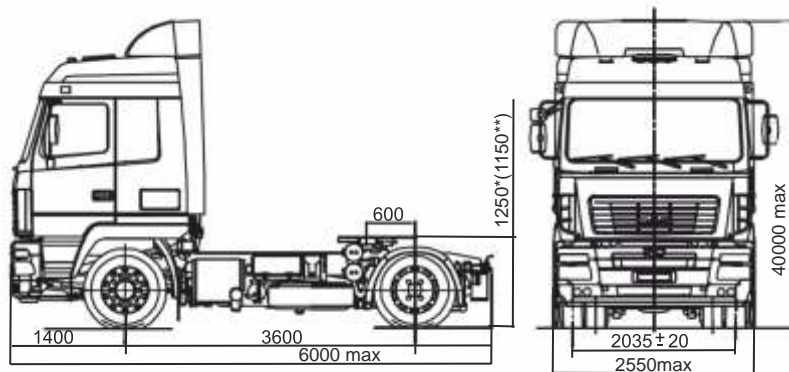

СЕДЕЛЬНЫЕ ТЯГАЧИ FIFTH-WHEEL TRACTORS

Предназначены для перевозки
различных грузов
в составе автопоезда

Designed for carrying forming part
of roadtrain of different loads

(4 2)

/ MAZ
-5440 9-8429
-5440 9-8479

/ with hydrosystem



		-5440 9-8429-013 (-5440 9-8479-013)
	/ Possible gross mass of roadtrain, kg	52000
	/ Possible gross mass of truck, kg	20450
	/ Distribution of gross mass :	
-	/ On front axle, kg	7450
-	/ On rear axle, kg	13000
	/ Loading on fifth wheel, kgf	12100
	/ Equipped truck mass,kg	8200
/ Engine		-651.10
	/ . . / Power, kW / hp	302 / 420
/ Gearbox		ZF 16S2520 TO (16JS200 TA)
/ Number of speeds of the gearbox		16
/ Rear suspension		/ multi spring with stabilizer
	/ Gear ratio	4,20
/ Fuel tank, l		500
	/ Maximum speed, km/h	85
/ Tyres dimensions		315/80R22.5
/ ab		5440 / large

*) / With speed-limiting device

/Technical data and dimension are given for standard configuration

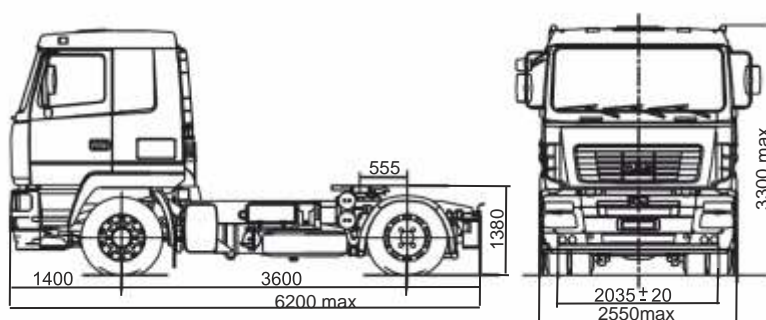



СЕДЕЛЬНЫЕ ТЯГАЧИ FIFTH-WHEEL TRACTORS

Предназначены для перевозки
различных грузов
в составе автопоезда

Designed for carrying forming part
of roadtrain of different loads

(6x4)

/ MAZ

-6430 9-8429

-6430 9-8479

/ with hydrosystem

-6430B9-8429-012
(-6430B9-8479-012)

/ with hydrosystem

	, / Tolerable gross mass of roadtrain, kg	65000
	, / Tolerable gross mass of truck, kg	33350
	/ Distribution of gross mass	
-	, / tolerable on front axle, kg	7350
-	, / tolerable on rear axle, kg	26000
	, / Tolerable loading on fifth wheel, kgf	23000
	, / Equipped truck mass,kg	10200
/ Engine		-651.10
	, / . . / Power, kW / hp	302 / 420
/ Gearbox		ZF 16S2520 TO (16JS200 TA)
/ Number of speeds of the gearbox		16
/ Gear ratio		4,2
/ Suspension		/ multi springs with stabilizer
	, / / Maximum speed, km/h	85
/ Tyres dimensions		315/80R22,5
, / Fuel tank, l		500
/ ab		5440 / large

*) / With speed-limiting device

/Technical data and dimension are given for standard configuration

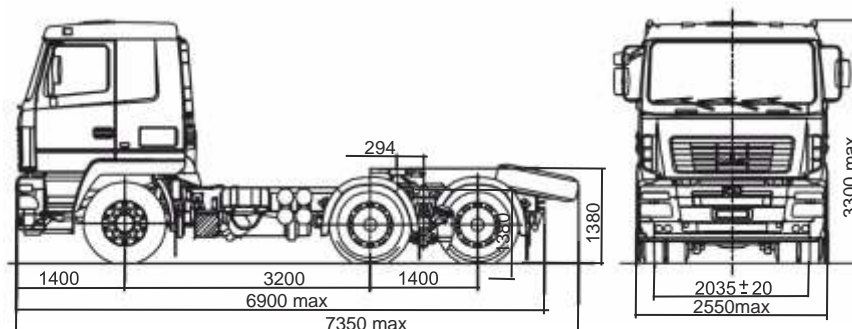



СЕДЕЛЬНЫЕ ТЯГАЧИ FIFTH-WHEEL TRACTORS

Предназначены для перевозки
различных грузов
в составе автопоезда

Designed for carrying forming part
of roadtrain of different loads

(6x4)

/ MAZ
-6430 9-1420
-6430 9-1470



-6430 9-1420-010, -6430 9-1470-010
(-6430 9-1420-020, -6430 9-1470-020)

		52000
Possible gross mass of roadtrain, kg		25850(25950)
Possible gross mass of truck, kg		
	/ Distribution of gross mass :	
-	/ On front axle, kg	6850(6950)
-	/ On rear axle, kg	19000
	/ Loading on fifth wheel, kgf	15900(15950)
	/ Equipped truck mass,kg	9800(9850)
Hs,	/ Height of fifth wheel, mm	1350 (1250)
	/ Maximum speed, km/h	85
/ Engine		-651.10
	/ Power, kW / hp	309 / 420
/ Gearbox		ZF 16S2520 ; 16JS200 T
/ Number of speeds of the gearbox		16
	/ Gear ratio	3.57
	/ Fuel tank, l	500
	/ Tyres dimensions	315/80R22.5 (295/80R22.5)
/ ab		6431 / large

	/ Suspension	
-6430 9-1420-010	-	/ multi springs with stabilizer
-6430 9-1420-020	-	4 / pneumatic 4 baloon
-6430 9-1470-010	-	/ multi springs with stabilizer
-6430 9-1470-020	-	4 / pneumatic 4 baloon
*)		/ With speed-limiting device

/ Technical data and dimension are given for standard configuration

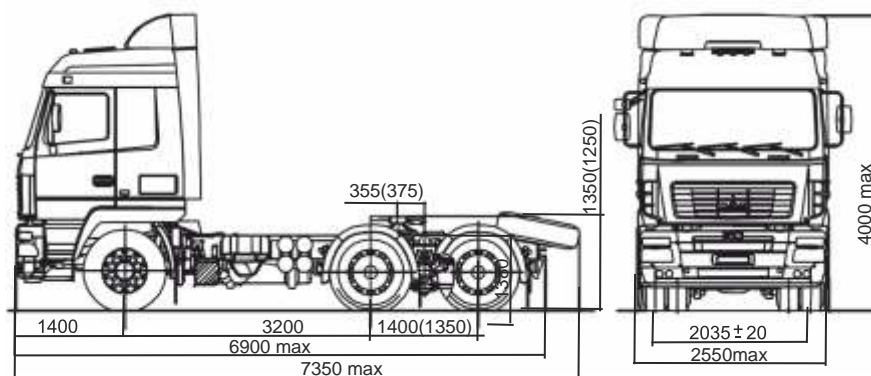



СЕДЕЛЬНЫЕ ТЯГАЧИ FIFTH-WHEEL TRACTORS

Предназначены для перевозки
различных грузов
в составе автопоезда

Designed for carrying forming part
of roadtrain of different loads

(6x6)

/ MAZ
-6425 9-450



-6425 9-450-051

	/ Possible gross mass of roadtrain, kg	65000
	/ Possible gross mass of truck, kg	30000
	/ Distribution of gross mass :	
-	/ On front axle, kg	7180
-	/ On rear axle, kg	22820
	/ Loading on fifth wheel, kgf	18000
	/ Equipped truck mass,kg	11900
	/ Maximum speed, km/h	68
/ Engine		-6585.10
	/ Power, kW / hp	309 / 420
/ Gearbox		12JS200TA
	/ Number of speeds of the gearbox	12
	/ Gear ratio	7,79
	/ Fuel tank, l	350+200
	/ Tyres dimensions	16,00R20
/ ab		/ large/
	/ Equipment particular	-

/Technical data and dimension are given for standard configuration

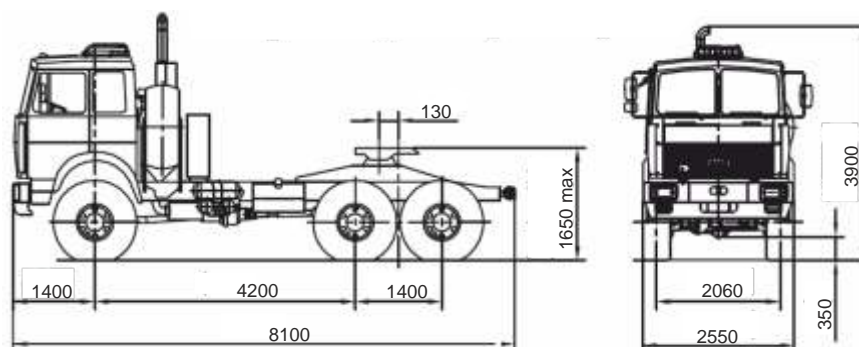

СЕДЕЛЬНЫЕ ТЯГАЧИ FIFTH-WHEEL TRACTORS

Предназначены для перевозки
различных грузов
в составе автопоезда

Designed for carrying forming part
of roadtrain of different loads

(6x6)

/ MAZ
-6425 9-433



-6425 9-433-000

	/ Possible gross mass of roadtrain, kg	65000
	/ Possible gross mass of truck, kg	32500
/ Distribution of gross mass :		
-	/ On front axle, kg	7000
-	/ On rear axle, kg	25500
	/ Loading on fifth wheel, kgf	21000
	/ Equipped truck mass,kg	11350
	/ Maximum speed, km/h	69
/ Engine		-6585.10
	/ Power, kW / hp	309 / 420
/ Gearbox		-239
	/ Number of speeds of the gearbox	9
	/ Gear ratio	6,59
	/ Fuel tank, l	350
	/ Tyres dimensions	12,00R20
/ ab		/
	/ Equipment particular	/

/Technical data and dimension are given for standard configuration

